

MAP of CLAYTON ST

From Survey made by order of the
Street Commissioners.
by N.B. Schubarth
Providence July 1861.

July 1861
0550

Scale 30 ft. to an inch
Measure U.S. Standard

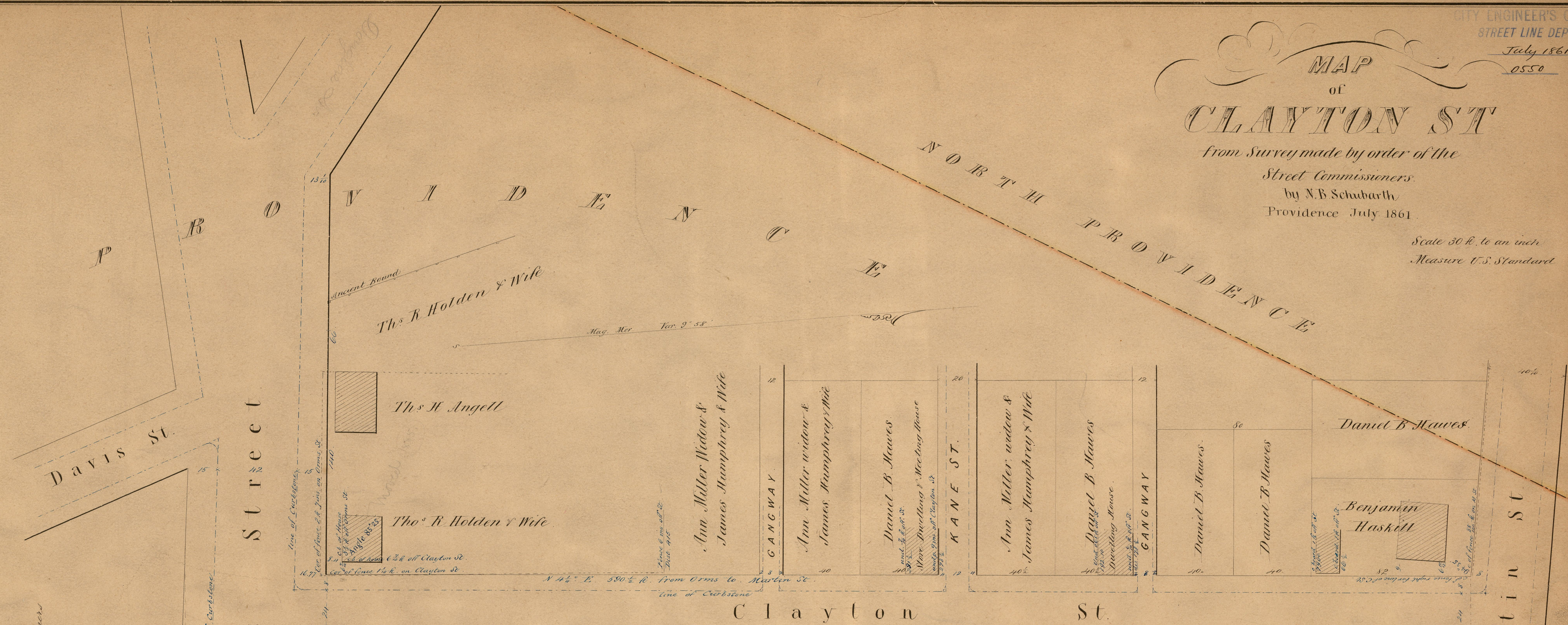

Orms Street

Clayton St.

Martin St.

Kane St.

Kane St.

Martin St.

PROFILE OF CLAYTON

(From Orms to Martin St)

Showing the grade as established July 1861 by the Street Commissioners

Scale Horizontal 40 ft. to an inch
Vertical 10 " " " do

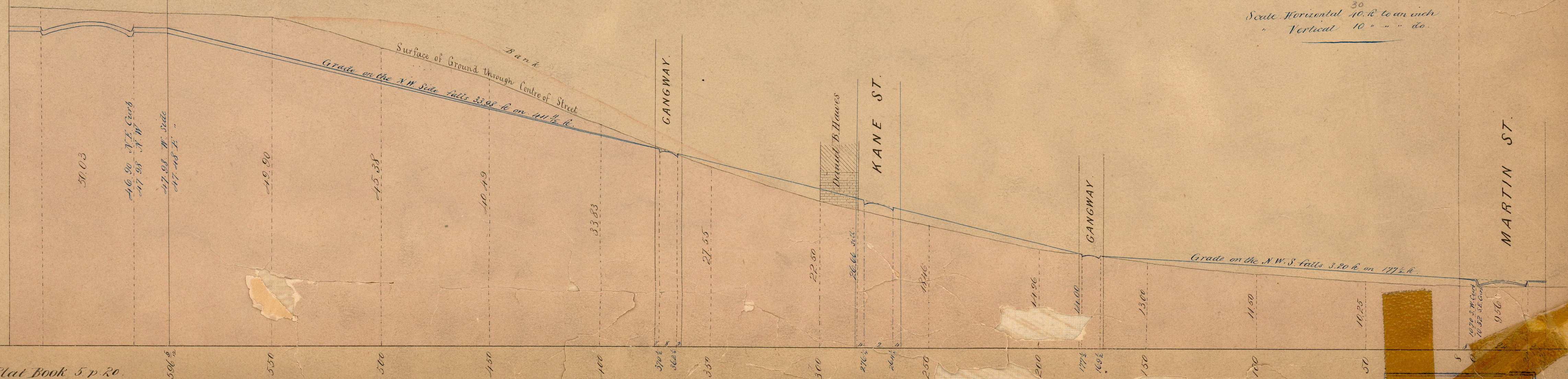

City of Providence Street Commissioners Office
July 1861.

The undersigned have caused this plat of Clayton St to be made defining the
lines of said St. also showing the grade, width of sidewalks &c as established
by this Board.

Josiah Simmons } Street
Edward Felt } Commissioners
Wm. H. Townsend }

COMPARED.
Alfred H. Combe

Copied from Plat Book 5 p 20

OFFICE
DRAWN BY
1861